

FB45 Series (Φ45 mm)

MOTOR FEATURE:

- RATED OUTPUT POWER : 18~24W
- RATED VOLTAGE : 12~24VDC
- OPERATIONAL SPEED : 2400~3600RPM
- MAX. OUTPUT POWER : 55W
- Sleeve/Steel Ball bearing for option
- Replaceable Brush Type for option
- Pinion shaft or other requirement for option



Dimensions

(UNIT:mm)

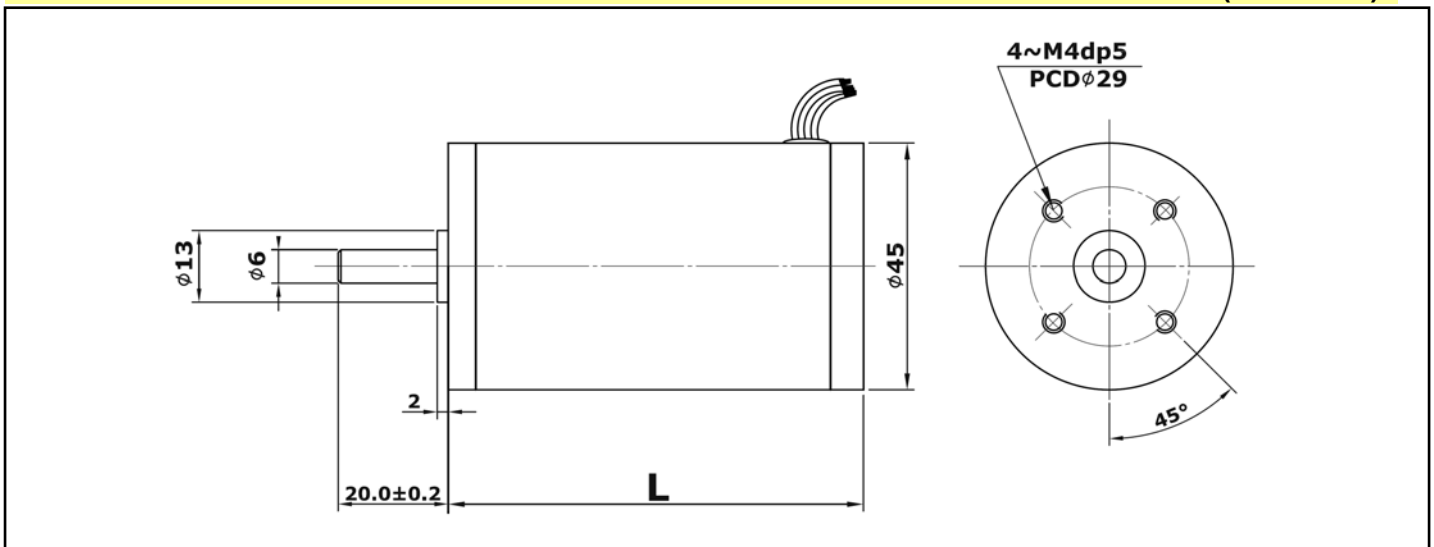

Typical Specifications (F =ferrite magnet, N= rare earth magnet)

MODEL	Rated						Weight (kg)	Length L (mm)
	Voltage (V)	Output (W)	Current (A)	Speed (RPM)	Torque (kgf-cm)	Rating		
FB45-N012020	12	18	2.31	3355	0.53	cont	0.7	77
FB45-N012015	12	14	1.71	2490	0.55	cont	0.7	77
FB45-N012016	24	16	0.98	2400	0.67	cont	0.7	77
FB45-N012025	24	24	1.44	3595	0.74	cont	0.7	77

- Pls discuss with us when you place an order non-standardized products such as voltage, speed and others.
- Mass production by standardizing the various types and manufacture the products with special size by order.
- Design or Motor spec. can be changed for quality improvement without any notice.

Copyright © 2012 Formosa Servo Electric Motor Co., Ltd./ EVERMO Group All Rights Reserved.