

FBE72 Series (Φ72mm)

MOTOR FEATURE:

- RATED OUTPUT POWER : 25W
- RATED VOLTAGE : 24VDC
- OPERATIONAL SPEED : 2000RPM
- MAX. OUTPUT POWER : 75W
- Sleeve/Steel Ball bearing for option
- Replaceable Brush Type for option
- Pinion shaft or other requirement for option



Dimensions

(UNIT:mm)

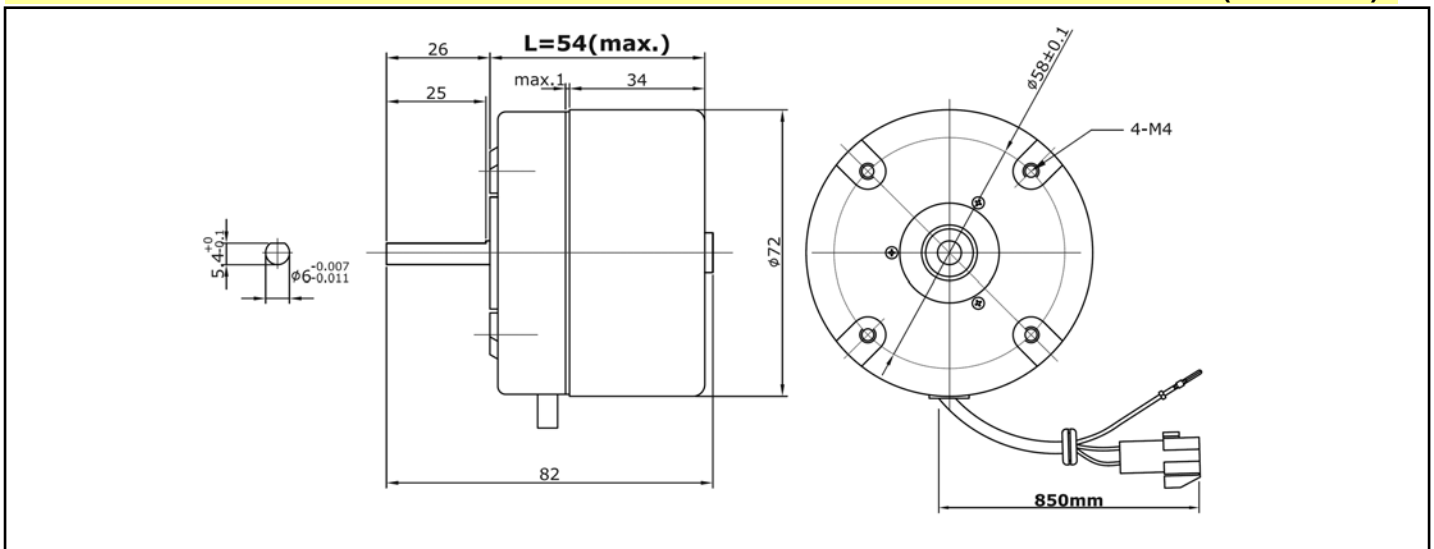

Typical Specifications (F=ferrite magnet, N=rare earth magnet)

MODEL	Rated							Weight (kg)	Length L (mm)
	Voltage (VDC)		Output (W)	Current (A)	Speed (RPM)	Torque (kgf-cm)	Rating		
	Operating	Nominal							
FBE72-N024025	18~32	24	25	1.4	2000	1.21	cont	0.75	54

- Pls discuss with us when you place an order non-standardized products such as voltage, speed and others.
- Mass production by standardizing the various types and manufacture the products with special size by order.
- Design or Motor spec. can be changed for quality improvement without any notice.