

FD100 Series (□ 100mm)

MOTOR FEATURE:

- RATED OUTPUT POWER : 150~600W
- RATED VOLTAGE : 24~220VDC
- OPERATIONAL SPEED : 1000~3000RPM
- MAX. OUTPUT POWER : 1800W
- Sleeve/Steel Ball bearing for option
- Replaceable Brush Type for option
- Pinion shaft or other requirement for option



Dimensions

(UNIT:mm)

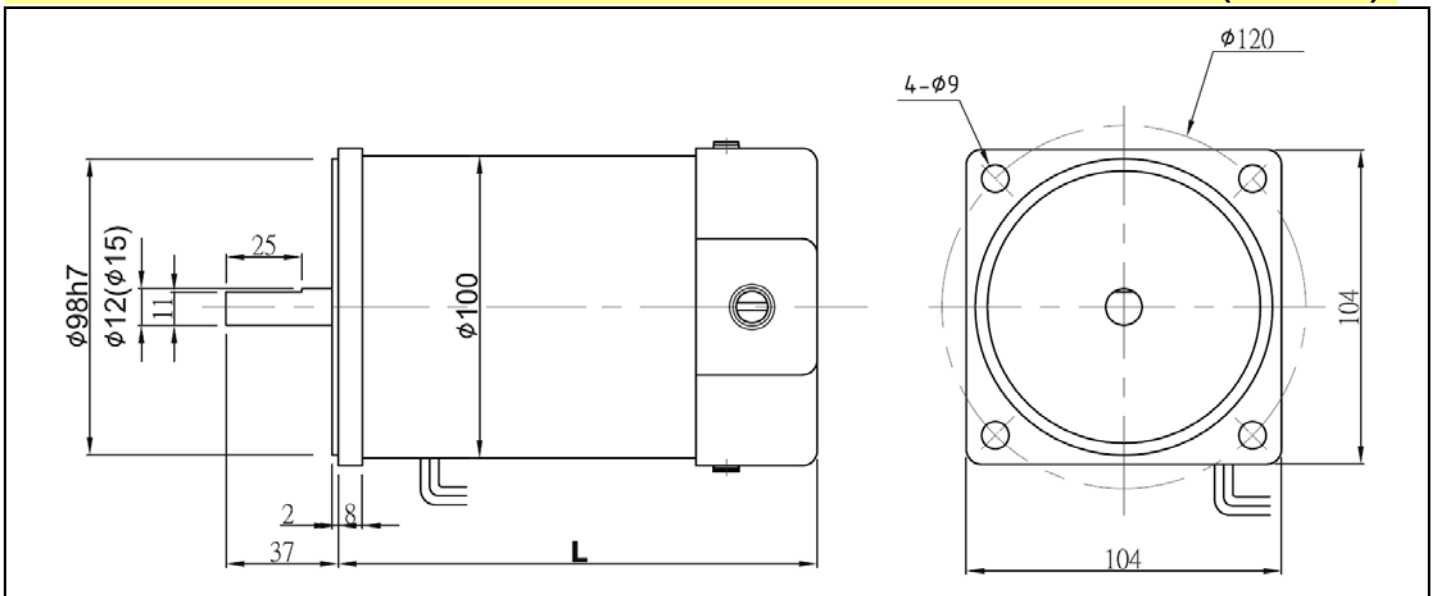

Typical Specifications (F = ferrite magnet, N= rare earth magnet)

MODEL	Rated						Weight (kg)	Length L (mm)
	Voltage (V)	Output (W)	Current (A)	Speed (RPM)	Torque (kgf-cm)	Rating		
FD100-F024150	24	150	9	1,000	14.5	cont	5.5	200
FD100-F048330	48	330	9.5	1,500	21.5	cont	5.5	200
FD100-F110280	110	280	3.6	1,500	18.2	cont	5.5	200
FD100-F160600	160	597	5.2	3,000	19.4	cont	5.5	200
FD100-F220230	220	231	1.5	1,500	15.0	cont	5.5	200
FD100-F220400	220	400	2.5	3,000	13.0	cont	5.5	200

- Pls discuss with us when you place an order non-standardized products such as voltage, speed and others.
- Mass production by standardizing the various types and manufacture the products with special size by order.
- Design or Motor spec. can be changed for quality improvement without any notice.

Copyright © 2012 Formosa Servo Electric Motor Co., Ltd./ EVERMO Group All Rights Reserved.