



ERS-9712SH

EVERMO®
DC MICRO MOTOR
 Carbon-brush motors

OUTPUT :92W~97W (APPROX)

WEIGHT :485 g (APPROX)

Typical Applications **Cordless Power Tools:** Drill, Cordless Garden Tool, Circular Saw
Others: Air pumps, Electric Fan, Geared Motor, Electric Model toy

Typical Specifications

MODEL	VOLTAGE		NO LOAD		AT MAXIMUM EFFICIENCY					STALL			
	OPERATING RANGE	NOMINAL	SPEED r/min	CURRENT A	SPEED r/min	CURRENT A	TORQUE g.cm	TORQUE mNm	OUTPUT W	EFF. %	TORQUE A	TORQUE g.cm	CURRENT mNm
ERS-9712SH-1974	90V~150V	125V CONSTANT	11000	0.20	9300	1.05	999	97.94	96.24	73	7.08	7670	751.96
ERS-9712SH-1639	90V~125V	125V CONSTANT	10200	0.23	8200	1.15	1094	107.25	92.23	65	5.00	5880	576.47

◎NOTE: 1)Casing ring 2) Ring varister 3) Capacitor for options only.

DIRECTION OF ROTATION

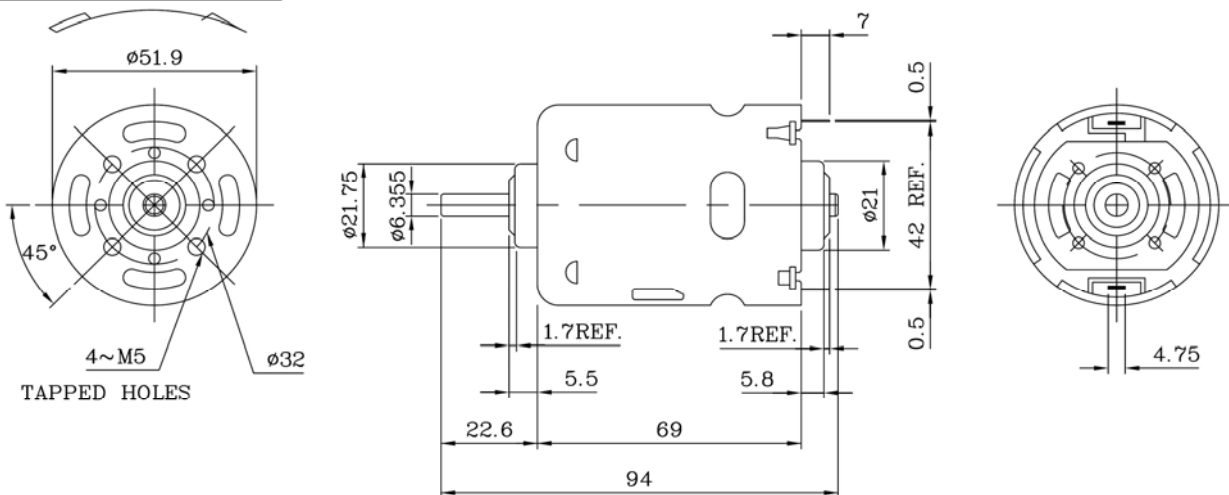

Usable machines screw length 4.0max from motor mounting surface.

UNIT: MILLIMETERS