



ERS-555SH

OUTPUT :4.7W~117W (APPROX)

WEIGHT : 190g (APPROX)

Typical Applications Home Appliances : Hair Dryer, Vending Machine, Geared Motor

Typical Specifications

MODEL	VOLTAGE		NO LOAD		AT MAXIMUM EFFICIENCY						STALL		
	OPERATING RANGE	NOMINAL	SPEED r/min	CURRENT A	SPEED r/min	CURRENT A	TORQUE		OUTPUT W	EFF. %	TORQUE		CURRENT
							g.cm	mNm			A	g.cm	mNm
ERS555SH-2462	12.0~24.0	12.0VCONSTANT	4000	0.15	3100	0.63	142	13.92	4.64	63	2.80	784	76.86
ERS555SH-3060	12.0~24.0	24.0VCONSTANT	9100	0.22	7700	1.52	341	33.43	27.22	74	10.62	2709	265.59
ERS555SH-5021F	6.0~24.0	24.0V CONSTANT	22800	1.30	20800	7.07	545	53.43	116.84	71	57.29	5252	514.71
ERS555SH-22105	12.0~36.0	28.0V CONSTANT	6200	0.12	5200	0.65	240	23.53	12.98	73	414	1834	179.80
ERS-555SH-18180R	4.5~9.0	9.0 V CONSTANT	1070	0.05	877	0.16	98	9.61	0.85	58.64	0.68	450	44.1
ERS-555SH-23100R	12.0~24.0	24.0V CONSTANT	5200	0.11	4501	0.70	275.5	26.70	12.15	72.32	4.50	2050	200.9

◎NOTE: 1)Casing ring 2) Ring varister 3) Capacitor for options only.

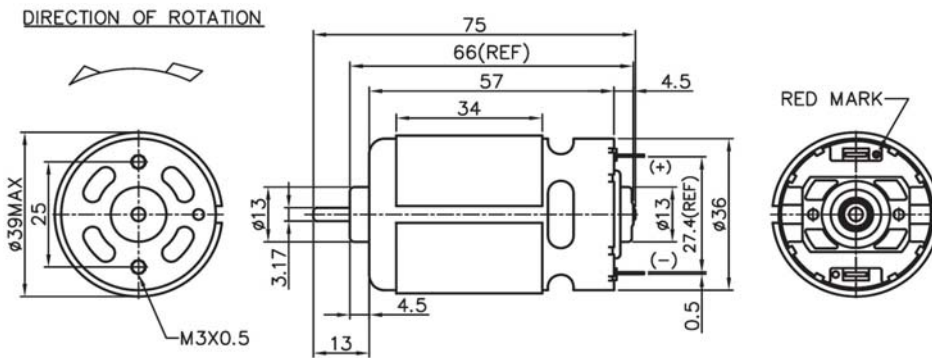

Usable machines screw length 4.0max.from motor mounting surface.

UNIT:MILLIMETERS